

70-K-53 - SPEEDLINE System Data Sheet - Version V1 (24-10-23)

SPEEDLINE 70mm 'C' Stud Partition @600mm Ctrs,
with Knauf 12.5mm Soundshield Plus each side

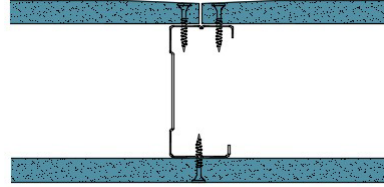

System Performance Breakdown

Fire Resistance:

BS476 Part 22:1987:

Test Ref & Date or Applied Ref & Report:

Max Height:

Thickness:

Duty Grade: BS 5234: Part 2:1992:

Sound Insulation:

30/30 Minutes (Integrity/Insulation).

BTC 17436F - BRE Report P102396-1011B

Refer to Speedline Specification Clause

97 mm. (At Base Track, Excluding Finishes)

Medium - Annexes A-F

42 R_wdB, Date Tested or Assessed Against - 28/06/2011

Test Code:
H17446AA
Test Date:
28/06/2011

| Freq. Hz | R dB |
|----------|------|
| 50 | 23.5 |
| 63 | 13.2 |
| 80 | 10.1 |
| 100 | 20.8 |
| 125 | 15.1 |
| 160 | 27.4 |
| 200 | 28.4 |
| 250 | 33.8 |
| 315 | 35.7 |
| 400 | 40.6 |
| 500 | 43.3 |
| 630 | 47.7 |
| 800 | 52.3 |
| 1000 | 55.6 |
| 1250 | 58.0 |
| 1600 | 60.2 |
| 2000 | 57.4 |
| 2500 | 44.5 |
| 3150 | 40.1 |
| 4000 | 43.3 |
| 5000 | 48.0 |
| 6300 | |
| 8000 | |
| 10000 | |

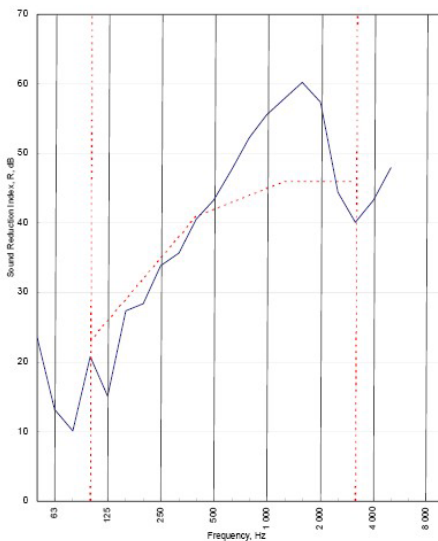

| | | | |
|---|--|-------------------------------|-------------------------------|
| Rating according to BS EN ISO 717-1:1997 | R_w (C;Ctr) = 42 (-4;-9) dB | | |
| Evaluation based on laboratory measurement results obtained by an engineering method: | Max dev. 10.9 dB at 125 Hz | | |
| | C ₅₀₋₃₁₅₀ = -5 dB | C ₅₀₋₅₀₀₀ = -4 dB | C ₁₀₀₋₅₀₀₀ = -3 dB |
| | C ₅₀₋₃₁₅₀ = -14 dB | C ₅₀₋₅₀₀₀ = -14 dB | C ₁₀₀₋₅₀₀₀ = -9 dB |

TESTED AT ONE OF THE UKAS ACCREDITED LABORATORIES BELOW

B.T.C (H-Ref on Graph)

B.R.E

AIRO

S.R.L

Customer: **Metsec plc Hepsec Division**

BTC 17446A: Page 8 of 10



SPEEDLINE Drywall Systems, Adsetts House, 16 Europa View, Sheffield Business Park, Sheffield, S9 1XH.

Tel: 0114 231 8030.

Email: enquiries@speedlinedrywall.co.uk

(As per the requirements set out in ISO/IEC 17025:2017 regarding test data the results stated have been carried out by voestalpine Metsec plc as part of the contract to supply Speedline Metal Sections to SIG Plc)